

WIFI BULLET CAMERA

QUICK START GUIDE

V1.0.0

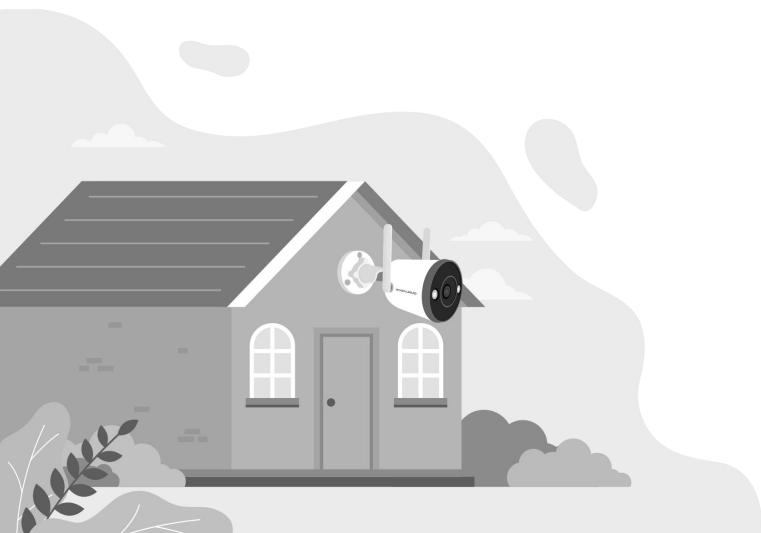

WHAT'S IN THE BOX

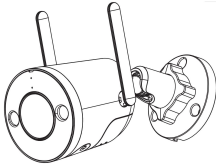

IP Camera (x1)

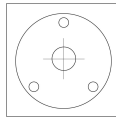

Drill Template (x1)

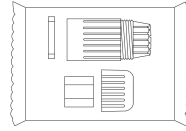

RJ45 Waterproof Cover (x1)

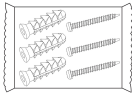

Mounting Screw Pack (x1)



Quick Start Guide (x1)



Qualified Certificate (x1)

1. APPEARANCE

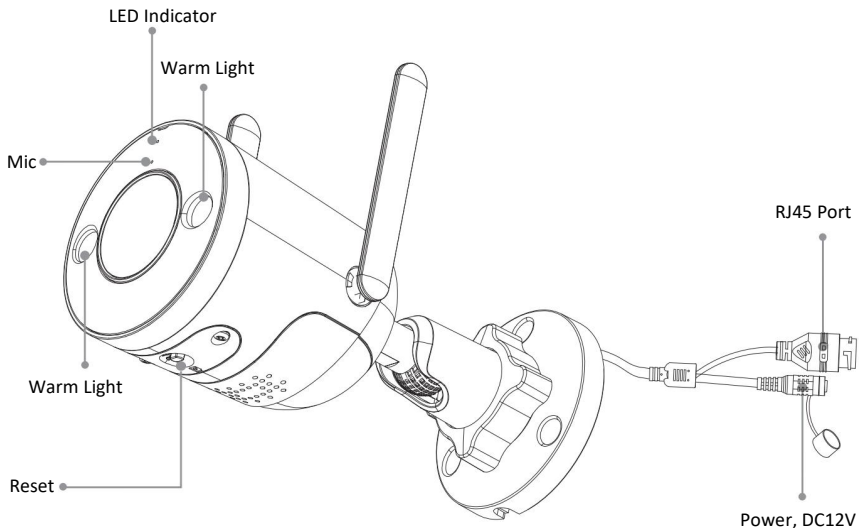

After power on, hold the reset button for 10 seconds, the camera will restore all configurations to default.

[NOTE] LED Indicator:

- **Red light always on:** camera power-up/resetting.
- **Red light blinks slowly:** camera upgrading.
- **Red light blinks rapidly:** waiting for network configuration.
- **Blue light blinks:** abnormal network status. Please check the connection between the camera and router.
- **Blue light always on:** camera is successfully connected to the network.

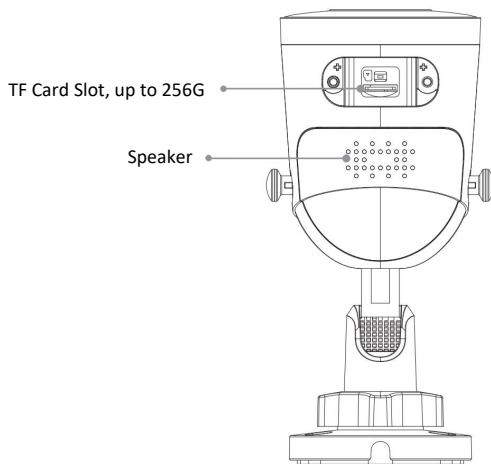

2. FAST CONFIGURATION

Step 1

Download and install the app.

1. Scan the QR code on the right to download Briton CCTV Pro App.
You can also search and get the app from Google Play Store(for Android users) or App Store (for Apple users).
2. Open the app, select the Home tab, register and log in.



IOS

Android

Step 2

Add camera to the app.

1. Powering up the camera, and you will see the camera's Indicator light blinking in red.
2. Click on the Devices tab of the Briton CCTV Pro app, and then click + icon. You can scan the QR code on the camera to add it to the app.

[NOTE] When configuring the network for the camera, connect your cell phone to a 2.4GHz-band Wi-Fi.



Click "+"

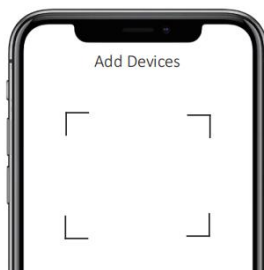

Scan QR Code

3. Follow the prompts to finish Wi-Fi configuration and network registration to the server, and bind the device to the app.

3. EQUIPMENT INSTALLATION

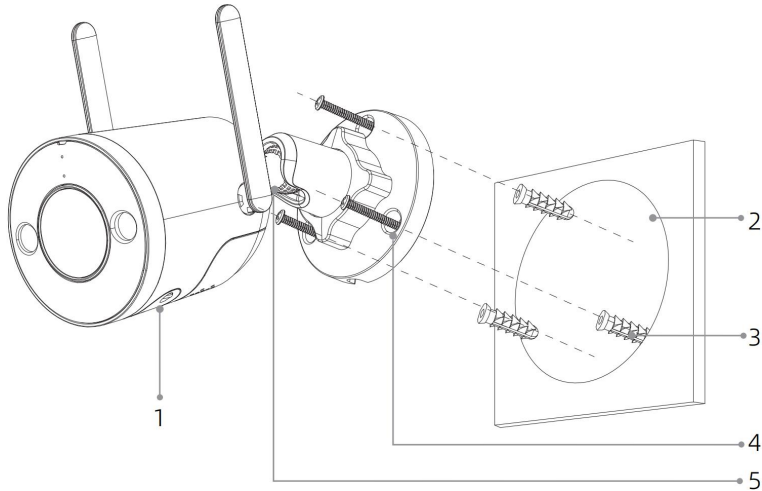

1. (Optional) Open the card cover with a screwdriver and insert a micro SD card into the slot and then re-install the cover.
2. Stick the Drill Template onto the wall.
3. Punch holes in the wall, and then install Expansion Bolts.
4. Tighten the screws and mount the camera onto the wall.
5. Connect the power supply and adjust the camera monitoring angle.

[NOTE] After the installation, please log into the Briton CCTV Pro app to initialize SD card before using it to record.

Installing RJ45 Waterproof Cover

1. Attach the sealing ring to the copper interface and insert the cable into the Ethernet copper interface.
2. Screw the waterproof bolt in.
3. Screw in the waterproof bolt lid.
4. Finish the installation.

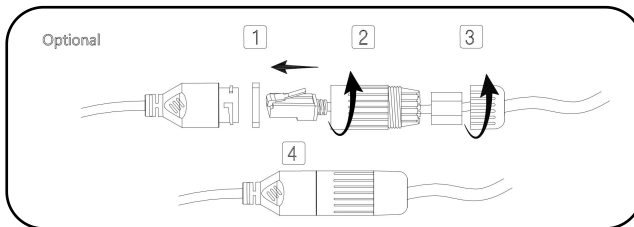

Connecting Power Cable

1. Connect the male and female ends of the power cord.
2. Wrap the male and female connectors with insulating tape.
3. Finish power cable waterproof.

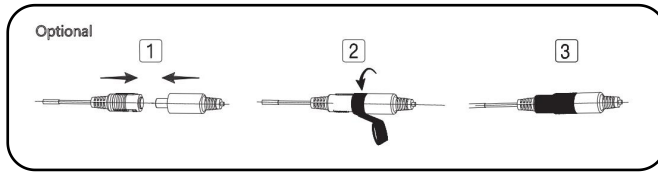

Confirm configuration

1. When you see the camera's indicator light turns blue and is always on, it indicates that the camera has been successfully configured and is functioning normally.
2. You can preview, do playback, monitor and change more configuration on the app.



4. CAUTION



This symbol is intended to alert users of important operations and maintenance instructions within the documentation accompanying the product.



This symbol is intended to alert users of uninsulated ‘dangerous voltage’ within the product enclosure that may be strong enough to pose a risk of electric shock to untrained personnel.

	CAUTION:	
	RISK OF ELECTRIC SHOCK. DO NOT OPEN	
SHOCK	CAUTION: To reduce the risk of electric shock. Do not remove cover or back. There are no user serviceable parts inside. Refer products to suppliers.	
CAUTION	To prevent electric shocks and risk of fire hazard, do not use unspecified power source.	



CAUTIONS:

- Please note the cameras operating temperature and its environment requirements. Avoid using the cameras in extremely high or low temperatures. The recommended operating temperature is -10~ +50°C. To avoid damage to the light processor (CMOS), do not expose the camera lens to direct sunlight or other bright light sources.
- Do not mount the camera near radiators or heat sources.
- The power supply must match the requirements of the camera. Ensure the output voltage, current, voltage polarity and operating temperature are within the range required by the camera power supply.
- During a thunderstorm, please ensure an anti-thunder device is connected or disconnect the power supply to the camera.